

# FOR LEASE

## DRUMHELLER BUILDING

21 W. ALDER ST. WALLA WALLA, WA



---

### Retail/Office Space in Historic Downtown Walla Walla 1,605 - 2,924 Sq. Ft. Space Available

---

- Centrally Located Perfect for Retail, Restaurant or Tasting Room
  - Storefront Facing Alder St.
  - Lots of Foot Traffic on Busy Intersection
  - Ample Parking - On-street 2-Hour Parking + 1 Block From All Day Free Parking Lot
  - Exposed Brick Walls, Concrete & Original Hardwood Floors
  - New HVAC System
  - Possibility for Outdoor Patio Seating
-

# CONCEPT LAYOUT

DEMISABLE TO ~1600 SQ. FT.

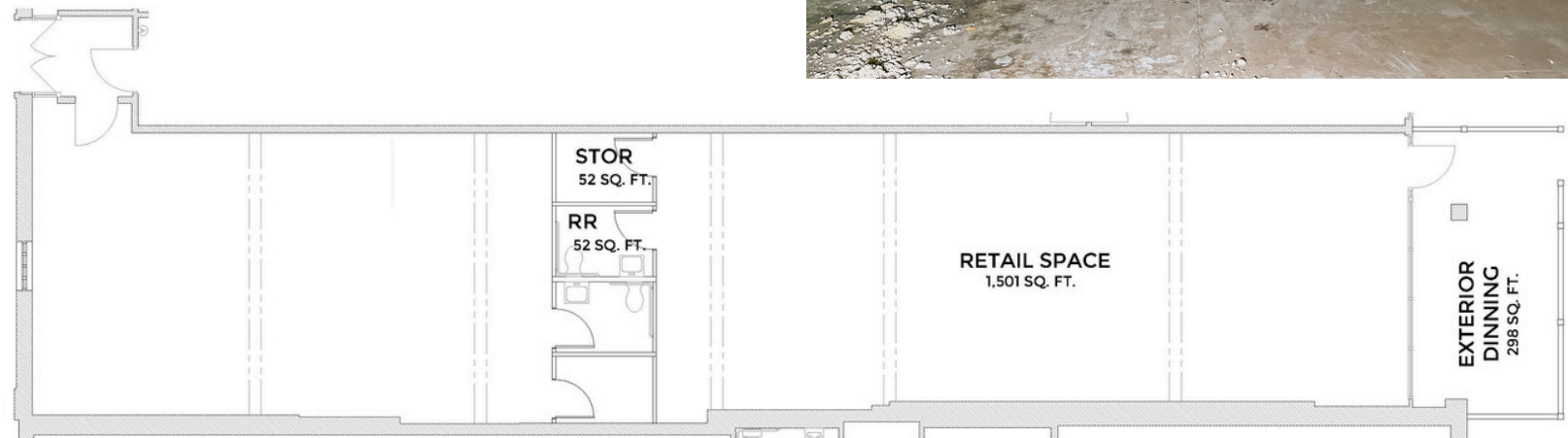

21 WEST ALDER (1,605 SF)



21 WEST ALDER (2,777 SF)